

# S-3

## Compact Stylish Mini-ITX Enclosure



### INTRODUCTION

iStarUSA new S-3 series offers both extreme performance & high capacity in a lightweight and compact aluminum-alloy enclosure. The S-3 Series proves that it is possible to build an enclosure for entertainment or industrial field. The aluminum front panel is crafted to achieve a generous feeling of substance by minimizing gaps and holes. Everything is either covered or hidden to make sure the look is as clean. It has one flush fitting door to cover all the front access I/O ports and drives. A system built with the S-3 will look great at all times even if it is not in use. The S-3 is compatible with the full range of Mini-ITX motherboards (17cmx17cm)

### FEATURES

- Ⓐ Smooth Aluminum Front Panel with Contemporary Touch
- Ⓑ Next Generation Cooling Performance
- Ⓒ Outstanding Potential for Silent Operation
- Ⓓ Conveniently Located Front I/O Ports
- Ⓔ Strategically Placed Side Ventilation Aid in Cooling

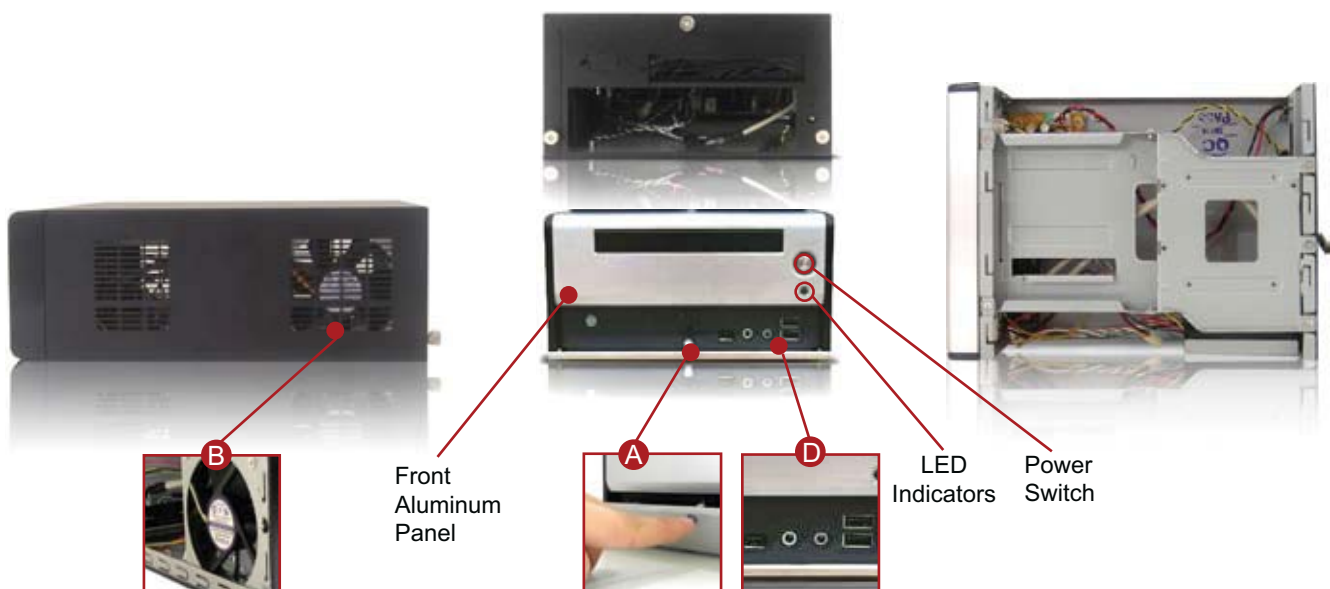

## ■ DRAWING

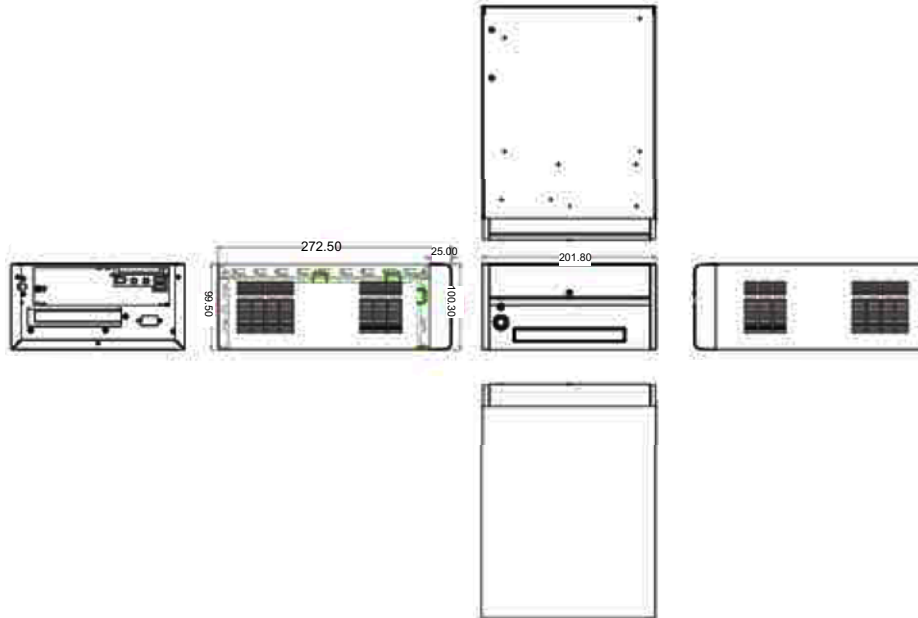

## ■ SPECIFICATIONS

<b>Model Number</b>	<b>S-3</b>	<b>Switches</b>	Power and Reset
<b>RoHS Compliance Version</b>	Yes	<b>Indicators</b>	Power and HDD Activity
<b>Standard Drive Bays</b>	3.5"/2.5" Drive: 1, Slim CD Drive:1	<b>Material of Front Bezel</b>	Aluminum
<b>Cooling Fan</b>	1 x 80mm	<b>Material of Main Chassis</b>	SECC Steel
<b>Mainboard Size [inch]</b>	6.7 x 6.7	<b>Accessories Included</b>	Assembly Kit, 2.5" HDD Cable, Slim-Optical Converter, Compact ATA Cable
<b>Expansion Slots</b>	1 x PCI32 Through a Riser Card [Optional]	<b>Power Supply</b>	80W AC/DC Adapter
<b>Front Connector</b>	USB2.0 x2, Audio, FireWire (IEEE1394)	<b>Dimensions (WxHxD)</b>	7.9 x 3.8 x 10.7 inch

## ■ POWER SUPPLY

<b>Input Voltage</b>	<b>11.4 ~ 12.6V DC</b>	<b>MTBF</b>	150k Hours at Full Load 25°C
<b>+3.3V</b>	Min: 0.1A / Max: 7.0A	<b>Dimensions ( W x H x D )</b>	160 x 15 x 45mm
<b>+5V</b>	Min: 1.0A / Max: 7.0A	<b>Cables Included</b>	1 x 20-pin ATX/ 2 x 4-pin device/ 1 x FDD power
<b>+12V</b>	Min: 0.5A / Max: 2.0A	<b>Adapter Input</b>	100~240V AC, 47~63Hz, 1.2A RMS(Max)
<b>-12V</b>	Max: 0.1A	<b>Adapter Output</b>	12V DC, 6.6A(Max)
<b>+5Vsb</b>	Max: 1.0A		
<b>+5V/ +3.3V Combined Output Power</b>	Max: 50W		

:: Specification and wiring diagram subject to change without notice

:: Limited Warranty

:: Last Update: Jan/2011

