



SWITCHING POWER SUPPLY SPECIFICATION

CP-02035-Q

CLAYPOWER
C O M P A N Y

REV.00

TEL 626.303.8885 FAX 626.301.0588

727 Philips Drive City of Industry, CA 91748

www.claypower.com

1. Input Characteristics:

1.1 Input Voltage Range --- 100~240Vac, full range with active power factor 90% min

1.2 Input Frequency Range --- 47Hz to 63Hz.

1.3 Input Ac Current (Max) --- 8.0A max, full load.

1.4 Inrush Current --- At 132Vac / 264Vac, full load condition, no damage occur, input fuse shall not blow.

1.5 Efficiency ---70% min, at nominal line input full load.

1.6 Input Leakage Current --- Leakage current from line to ground will be less 10mA rms, measurement will be made at 240Vac/60Hz.

2. Output Characteristics:

2.1 Static Output Characteristics.

Output Voltage	Load Range		Regulation		Ripple Max mV P-P	Ripple & Noise Max. mV P-P
	Min.	Max.	Min.	Max.		
1. +3.3 V	0.5 A	20.0 A	- 5 %	+ 5 %	50 mV	100 mV
2. +5.0 V	0.3 A	30.0 A	- 5 %	+ 5 %	50 mV	100 mV
3. +12.0 V	1.0 A	25.0 A	- 5 %	+ 5 %	100 mV	150 mV
4. -5.0 V	0.0 A	0.5 A	- 10 %	+ 10 %	150 mV	200 mV
5. -12.0 V	0.0 A	0.5 A	- 10 %	+ 10 %	150 mV	200 mV
6. SB +5.0 V	0.0 A	3.0 A	- 5 %	+ 5 %	100 mV	100 mV

Note:

1. Noise Test --- Noise bandwidth is from Dc to 20MHz.
2. Ripple frequencies greater than 1 MHz shall be attenuated by the measurement system.
3. Add 0.1uF / 10uF capacitor at output connector terminals for ripple & noise measurements.
4. Combined total power from +3.3V and +5V rails shall not exceed 150W.
5. The total output power shall not exceed 350W.

2.2 Dynamic Output Characteristics:

2.2.1 Initial Delay Time --- NONE.

2.2.2 Rise Time --- 50 mS max, at nominal line full load.

2.2.3 Turn-on Delay Time --- 600mS max, at nominal line full load.

2.2.4 Hold-up Time --- 16mS min. for + 5V output at nominal line full load.

2.2.5 Transient Overshoot --- 10% max. of delay state after load change of 25% within the range of 50% to 100% of full load.

2.2.6 Temperature Coefficient --- 0.03% per °C max.

3. Protections:

**3.1 Over Voltage Protection --- Standard on +3.3V output set at 3.7Vdc – 4.5Vdc.
+5.0V output set at 5.7Vdc – 6.5Vdc.
+12.0V output set at 13.5Vdc – 14.5Vdc.**

3.2 Short Circuit Protection --- A short circuit placed between DC return and output shall cause no damage and the power supply shall shutdown.

3.3 Over Power Protection --- The power supply can use electronic circuit to limit the output. Power against excessing +115% - 150% of full load, or protected against excessive power delivery due to short circuit of any output or over total power.

3.4 No load Operation --- No parts damaged on power supply.

4. Dielectric Withstand Voltage:

4.1 Primary to Secondary ----- 1500Vac for 1 minute. Or 2200Vdc for 3 sec.

4.2 Primary to Safety Ground --- 1500Vac for 1 minute. Or 2200Vdc for 3 sec.

4.3 Insulation Resistance ----- Primary fo safety ground - 500Vdc, 100M ohms min.

5. Conducted EMI: Internal Filter Can Meet.

5.1 FCC Requirement --- Part15, SUB-Part J, Computing Devices “ Class B “ Limits.

5.2 VDE Requirement --- Class “ B “ (General Operating Permit) Requirements Of VFG 234/1991.

5.3 CISPR Requirement --- Class “ B “ Requirements Of CLSPR 22.

5.4 Harmonic Requirement --- IEC61000-3-2 & IEC61000-3-3 Class “ D “.

6. Product Safety: This Power Supply Is Designed Can Meet The Following Spec.

6.1 UL/CUL ----- UL60950-1

6.2 TUV ----- EN 60950-1

7. Environment:

7.1 Operation Temperature ----- Air temperature 0 °c to 50 °c.

7.2 Operation Relative Humidity ----- 20% to 90%.

7.3 Storage Temperature ----- Air temperature -20 °c to 60 °c.

7.4 Storage Relative Humidity ----- 5% to 95%.

7.5 Altitude ----- Operate properly at any altitude between
0 To 100,000 feet, storage 40,000 feet.

7.6 Vibration ----- 0.38mm. 5-55-5Hz, 1 minutes per cycle;
30 minutes for each axis (X,Y,Z).

8. Burn-In

8.1 Burn-In ----- At 45 °C, max. load, 4 hours.

9. Mean Time Between Failure ----- 60 KHrs minimum at 75% load for
25 °C ambient temperature.

10. Power-Good Signal:

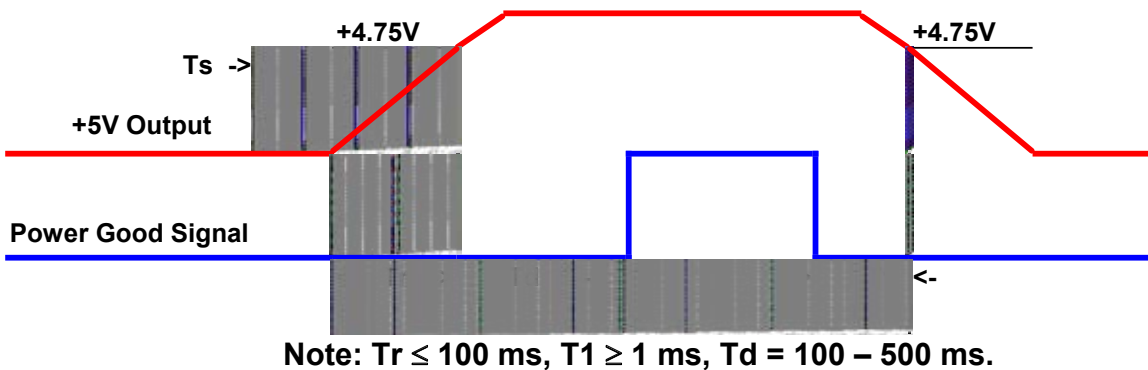

11. Fan control curve:

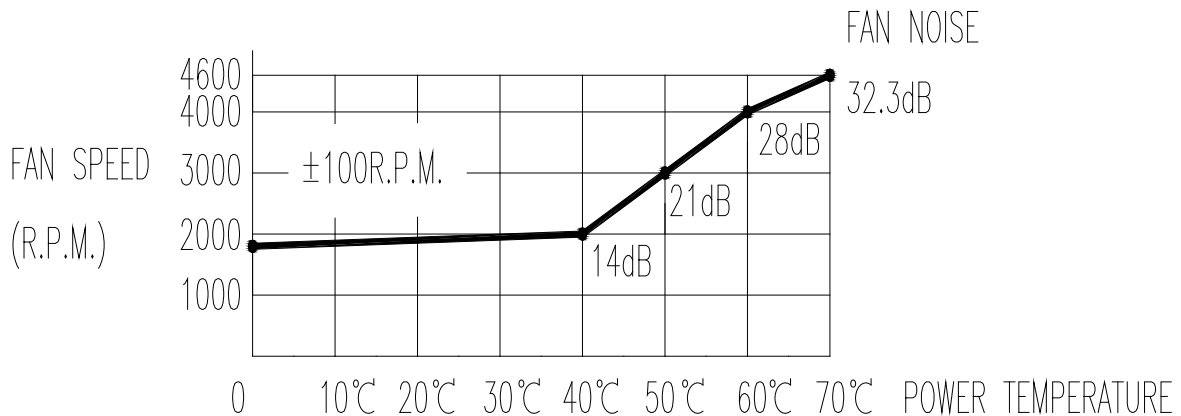

12. Dimension

11.1 W x H x D ----- 100.0 x 70.0 x 200.0 (mm)

REVISIONS		
NO	DESCRIPTION	DATE

浮高5MM或平貼機箱

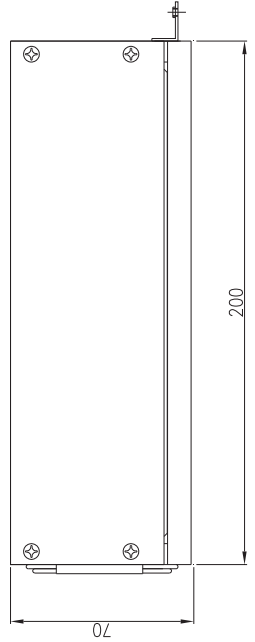
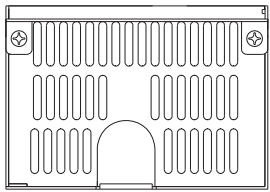
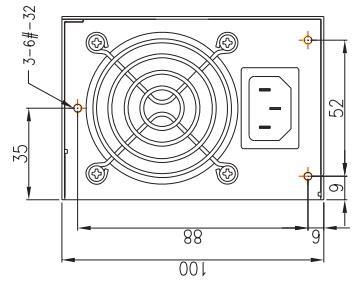
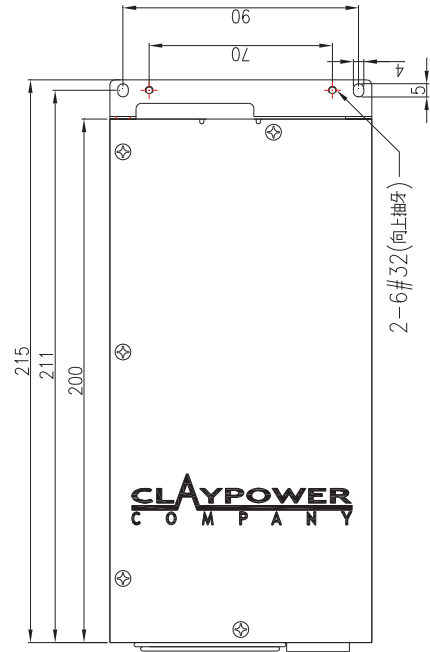
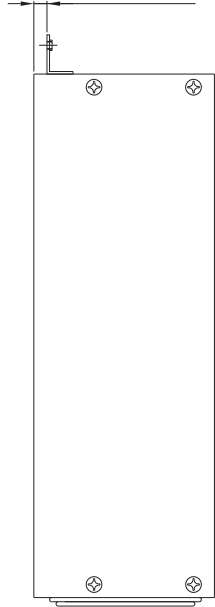

CLAYPOWER COMPANY		DATE	TITLE	PART NO.
APPROVED	CHECKED	DATE	SCALE: MM(INCHES)	CP-02035-Q
DESIGNED	DESIGNED	DATE	SCALE: MM(INCHES)	PRX 2U
		06/18/08	1:2.5	PRX 2U
			TOLERANCES:	MODEL NO.
			.XX = ±.10	
			.XXX = ±.010	PRX 2U
				REV.
				A0
				SHEET
				1 of 1

FINISH:	MATERIAL:		
第三角法 (Projection)	採購	生產	品質